



RULON INTERNATIONAL

Wood Squares
Installation Guide

Rulon Wood Squares Ceiling Installation Guide

Receipt and Storage:

- a. All material shall be delivered to the project site in the original, labeled, unopened packages. Keep packages of components unopened until it is time to acclimate to the building conditions
- b. Material shall be stored flat and level in a fully enclosed space. **DO NOT Store Rulon products in direct sunlight.** Seventy-two hours before beginning ceiling installation, wood strips must be moved into the room where the HVAC system is operating and the packaging shall be opened. This is to allow the boards to adjust to the room environment. Wood panels are to be stored off the floor.
- c. Care in handling must be exercised to avoid damage.

Before You Begin Installation:

- a. Ensure that all necessary tools are available (see below)
- b. Check Ceiling components to ensure all items required are at hand
- c. Review this guide in its entirety. If you have any questions, call Rulon Company before you start the installation

If You Need Further Assistance:

- If you have any questions, or if you encounter a situation not covered by this installation guide, contact the Rulon Technical Department.

Phone: 1-800-22RULON (1-800-227-8566)

Fax: 1-904-584-1499

Tools and Equipment:

- Standard leveling devices
- Saber saw
- Miter saw
- Table Saw
- Painters tape

References:

- ASTM C-635 – Standard Specification for the Manufacture, Performance, and Testing of Metal Suspension Systems for Acoustical Tile and Lay-In Ceilings
- ASTM C-636 – Standard Practice for the Installation of Metal Ceiling Suspension Systems for Acoustical Tile and Lay-In Ceilings
- Optional: ASTM E-1264 – Standard Classification of Acoustical Ceiling Products
- Optional: Seismic Considerations – Refer to Local Code

Rulon Wood Squares Ceiling Installation Guide

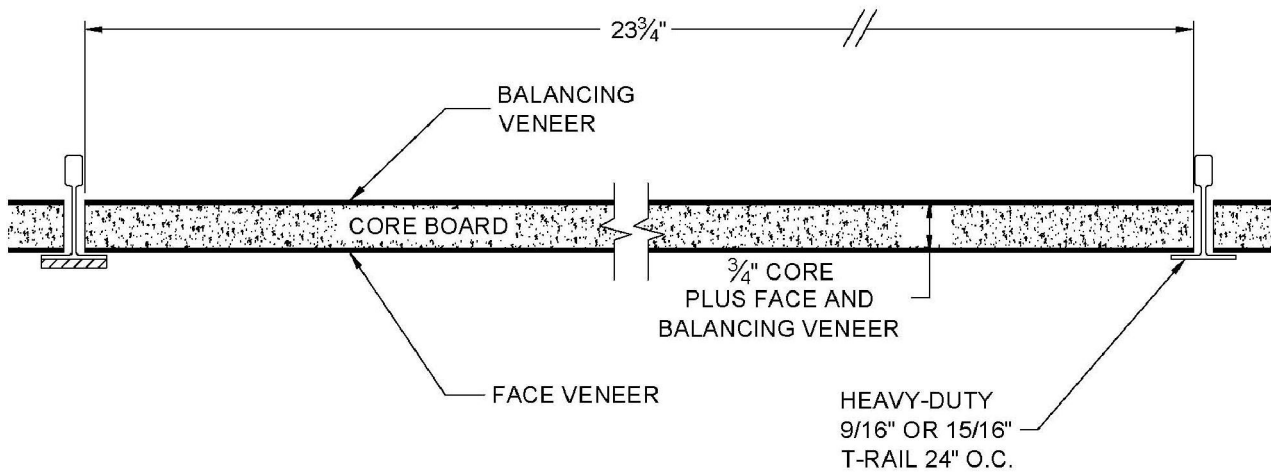

Lay-in Square Profile Shown

(see page 3 for additional profiles)

(Reference Shop drawings for profiles not shown in installation guide such as coffered etc.)

Ceiling Components:

Supplied by Rulon:

- Wood Squares
- Perimeter and border trim (when specified)
- Touch-up finish

Supplied by Others:

- $\frac{9}{16}$ " or $\frac{15}{16}$ " Heavy-Duty T-Rail Grid System
- Acoustical Blanket (when specified)
- Perimeter angle or hardware for trim installation

Rulon Wood Squares Ceiling Installation Guide

Other Profiles:

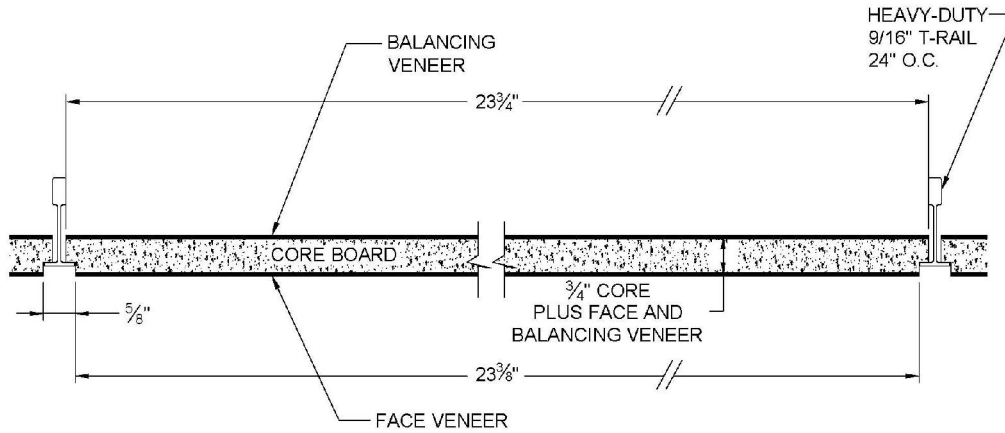

Standard Tegular Profile for 9/16" Grid

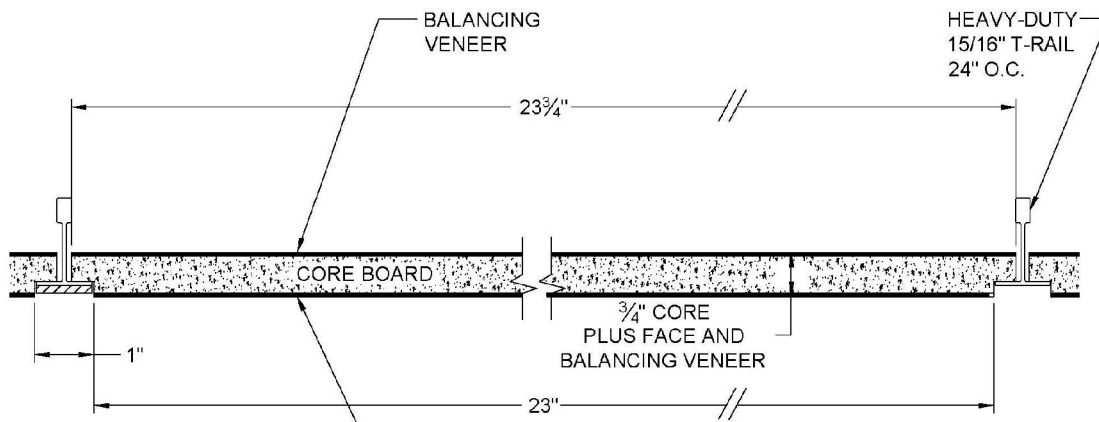

Standard Tegular Profile for 15/16" Grid

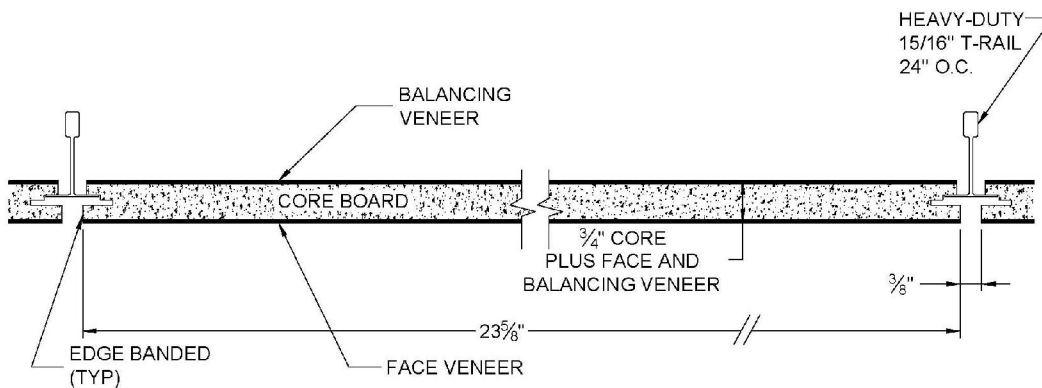

Edge Banded Side Slot square Profile

Rulon Wood Squares Ceiling Installation Guide

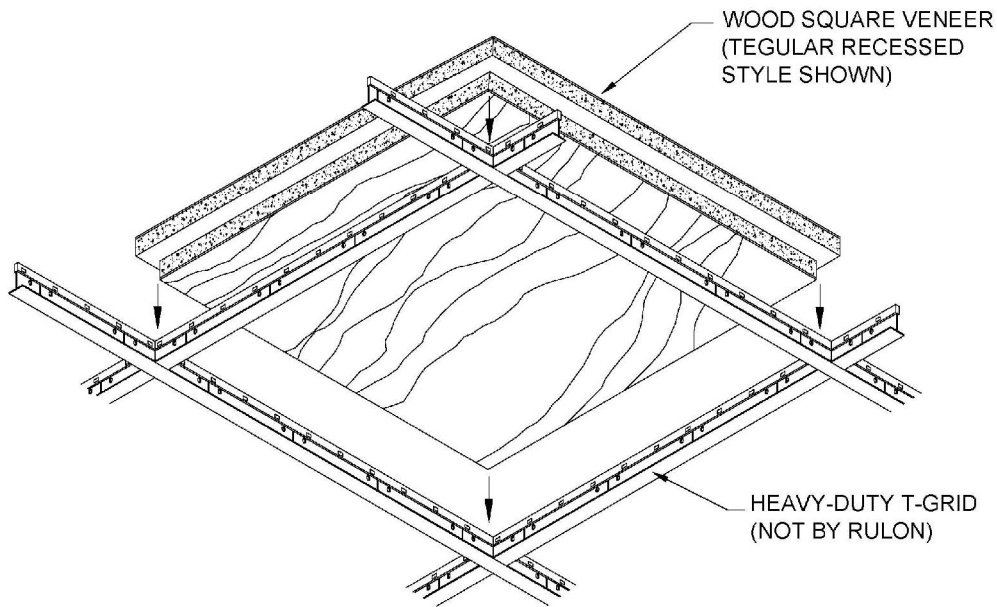

Step 1: Ceiling Grid Preparation

Level and install heavy duty grid throughout the installation area. Heavy duty grid mains shall be supported a maximum of 4' On Center with #12 Gauge Hanger wire. If acoustical insulation is required, install prior to laying in panels.

Step 2: Installing Panels

Install panels as in sketch above. For side slot installation, refer to three steps below.

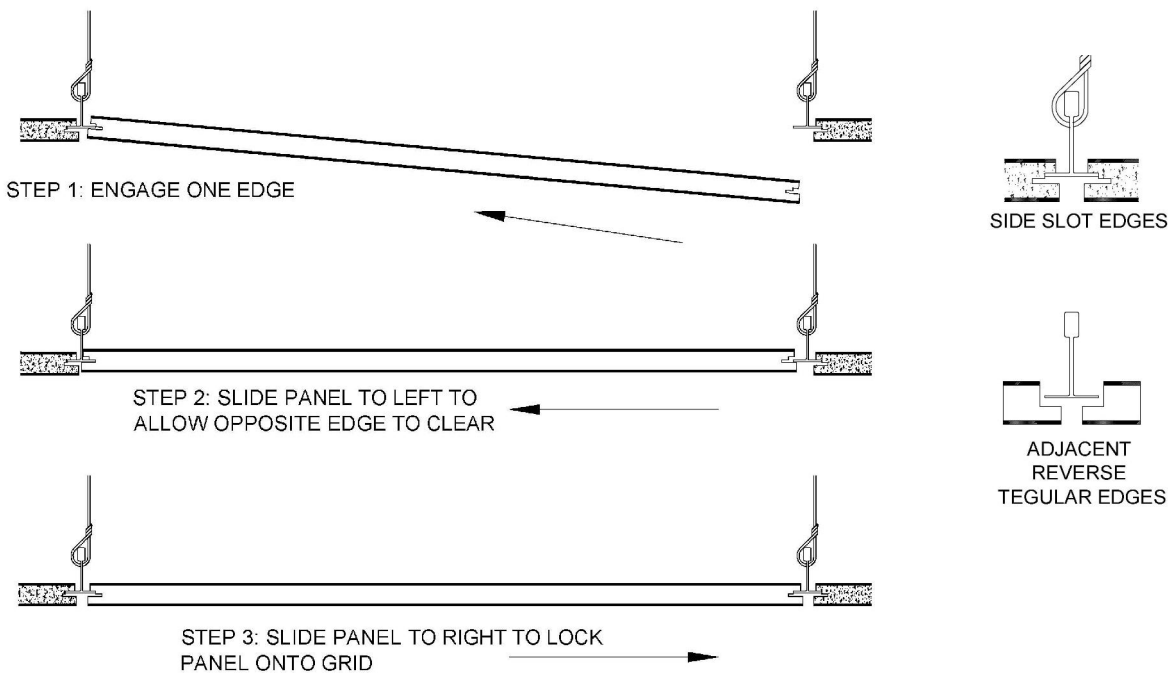

Rulon Wood Squares Ceiling Installation Guide

Step 3: Perimeters and penetrations

Panels are to be field-trimmed to fit site conditions. Trimming should be done with the appropriate saw, with painters tape on the veneer side to prevent splintering.

Penetration cuts require a saber/jig saw, and perimeter cuts require a miter saw. Cut panels should be touched up with Rulon-supplied finish.

Step 4: Cleanup

1. Clean all wood panels and borders free of dirt, dust, grease, oils, and fingerprints. Routine cleaning is best accomplished with a soft, lint-free cloth lightly dampened with water or an inert household dust attractant. Allowing airborne dust, which is somewhat abrasive, to build up will tend to dull a finish over time. Refer to the Rulon Care and Maintenance document for further instructions.
2. Remove and replace all work that cannot be successfully cleaned or repaired