



RULON INTERNATIONAL

Aluratone 900 Series Tongue and Groove
Wall Panels
Installation Guide

Rulon Aluratone 900 Series T&G Wood Walls Installation Guide

Receipt and Storage:

- a. All material shall be delivered to the project site in the original, labeled, unopened packages. Keep packages of components unopened until it is time to acclimate to the building conditions
- b. Material shall be stored flat and level in a fully enclosed space. **DO NOT Store Rulon products in direct sunlight.** Seventy-two hours before beginning ceiling installation, wood strips must be moved into the room where the HVAC system is operating and the packaging shall be opened. This is to allow the boards to adjust to the room environment. Wood panels are to be stored off the floor.
- c. Care in handling must be exercised to avoid damage.

Before You Begin Installation:

- a. Ensure that all necessary tools are available (see below)
- b. Check Wall components to ensure all items required are at hand
- c. Review this guide in its entirety. If you have any questions, call Rulon Company before you start the installation

If You Need Further Assistance:

- If you have any questions, or if you encounter a situation not covered by this installation guide, contact the Rulon Technical Department.

Phone: 1-800-22RULON (1-800-227-8566)

Fax: 1-904-584-1499

Tools and Equipment:

- Standard leveling devices
- Saber saw
- Miter saw
- Table Saw
- Nail gun
- Painters tape
- Colored putty/ fill crayons

Rulon Aluratone 900 Series T&G Wood Walls Installation Guide

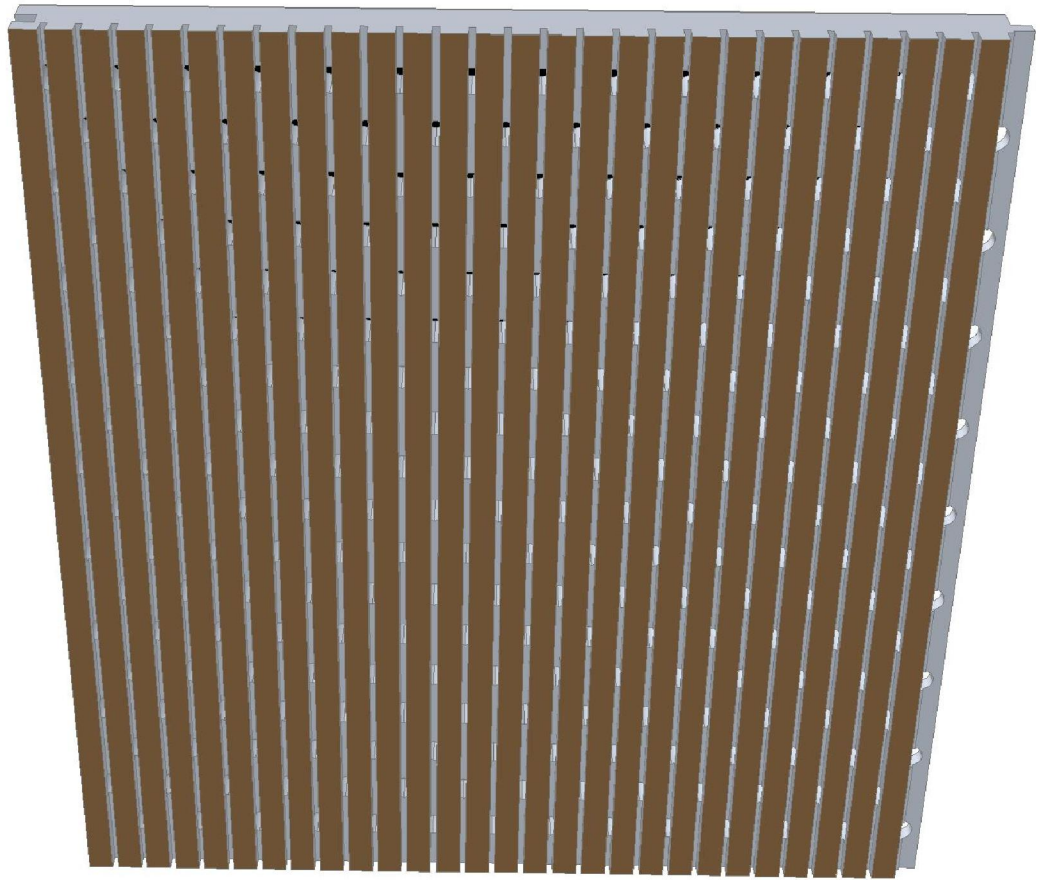

Wall Components:

Supplied by Rulon:

- Acoustical Tongue and Groove Panels (shown above)
- Perimeter and border trim (when specified)
- Touch-up finish

Supplied by Others:

- 1½" finishing nails
- Furring strips
- Acoustical Blanket (when specified)

Rulon Aluratone 900 Series T&G Wood Walls Installation Guide

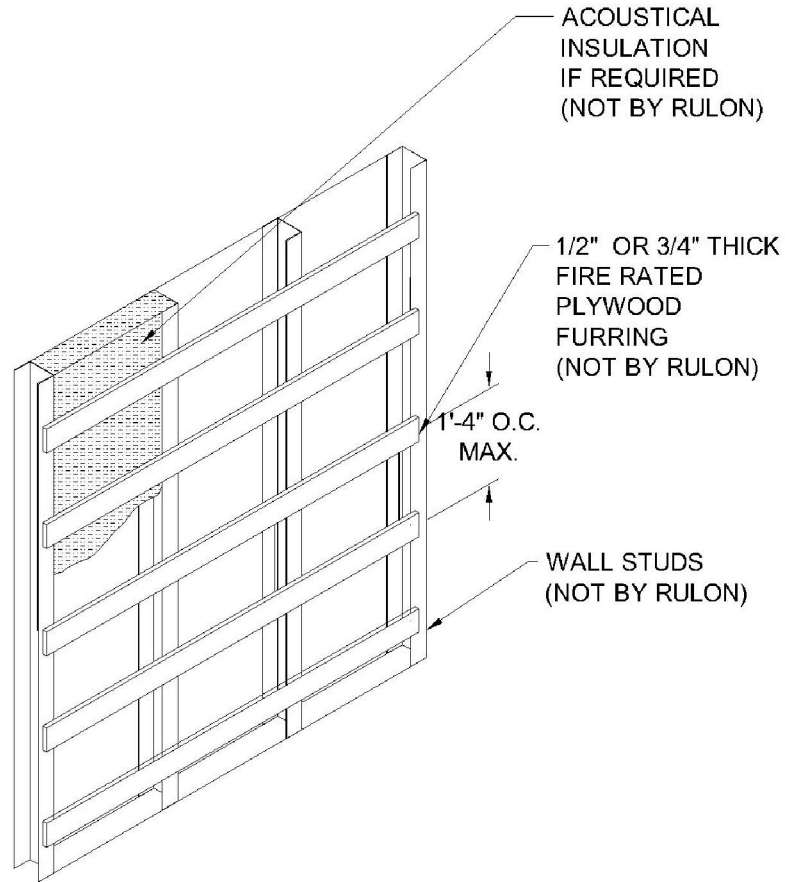

Step 1: Wall Preparation

Level and Install furring strips across wall studs as shown above. If acoustical insulation is required, install prior to attaching panels.

Rulon Aluratone 900 Series T&G Wood Walls Installation Guide

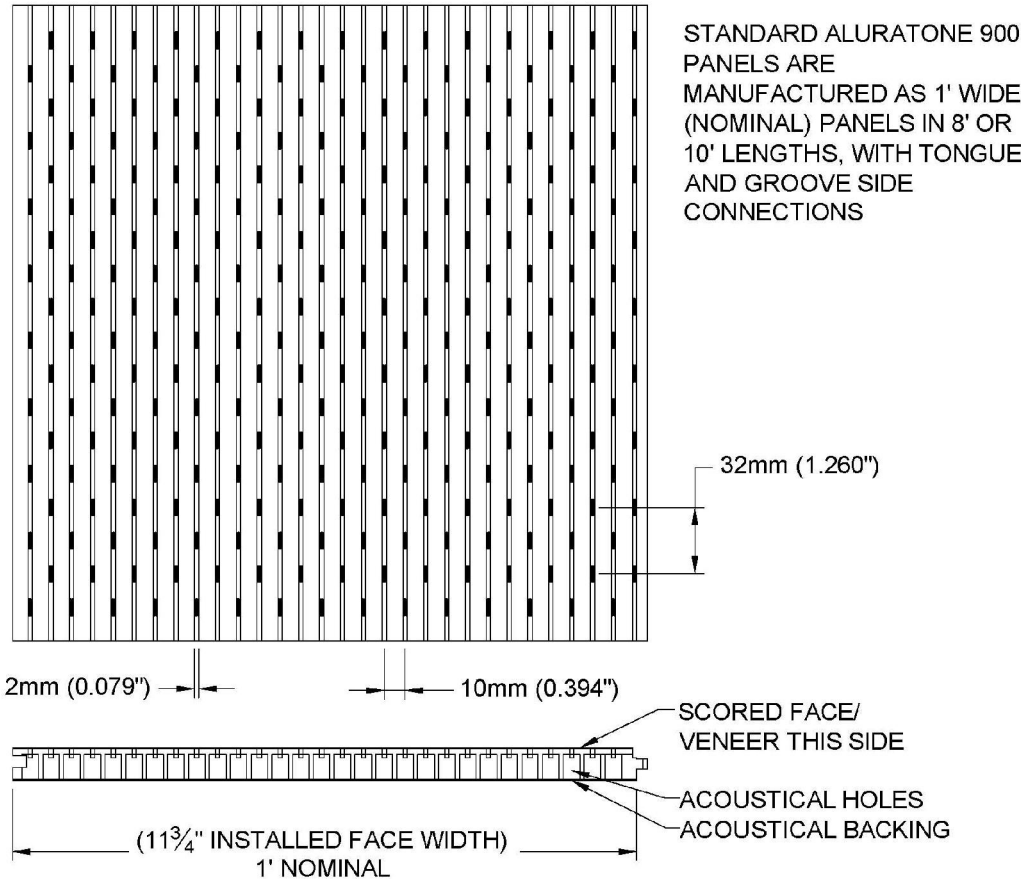

Important Note: Installed Dimension

As detailed above, the installed dimension of a 1' Nominal Width Panel is 11³/₄" for typical Aluratone 900 Tongue and Groove. If panels were manufactured to a different size than this, please consult Rulon submittal documents for the installed dimension.

Rulon Aluratone 900 Series T&G Wood Walls Installation Guide

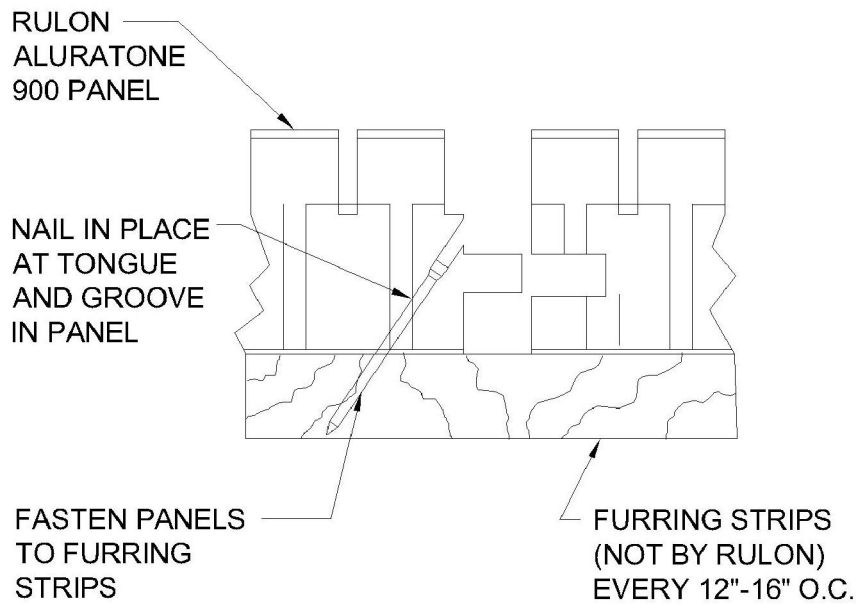

Step 2: Installing Panels

Fasten panels to furring with appropriate nails through tongue. The initial panel may need to be face-nailed close to groove side, filled, and touched-up in the field.

Rulon Aluratone 900 Series T&G Wood Walls Installation Guide

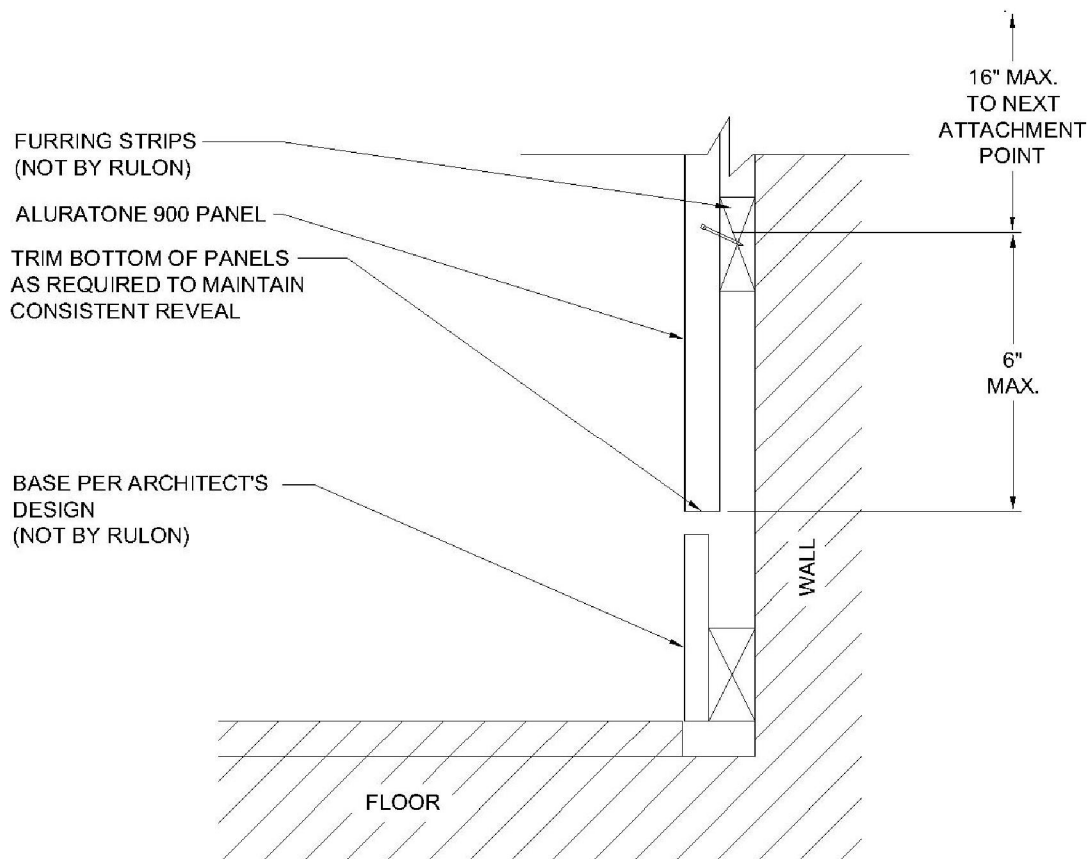

Step 3: Bases and Borders

Panels are to be field-trimmed to fit site conditions. Trimming should be done with the appropriate saw, with painters tape on the veneer side to prevent splintering. Penetration cuts require a saber/jig saw, long-dimension cuts/rips required a table saw, and cross-cuts require a miter saw. Cut panels should be touched up with Rulon-supplied finish.

Step 4: Cleanup

1. Clean all wood panels and borders free of dirt, dust, grease, oils, and fingerprints. Routine cleaning is best accomplished with a soft, lint-free cloth lightly dampened with water or an inert household dust attractant. Allowing airborne dust, which is somewhat abrasive, to build up will tend to dull a finish over time. Refer to the Rulon Care and Maintenance document for further instructions.
2. Remove and replace all work that cannot be successfully cleaned or repaired.

Rulon Aluratone 900 Series T&G Wood Walls Installation Guide

Optional: Access Panel Detail

